



SPEAKMAN®

SENSORFLO® Faucets & Soap Dispensers

Upgrade Restrooms For A More Hygienic Environment

For 150 years, Speakman products have elevated the design and performance of hotels and commercial projects around the globe.. SENSORFLO® fixtures are hygienic, sensor operated fixtures that are designed and engineered in accordance with the highest quality and performance standards. Utilizing the most up-to-date laser technology, providing efficiency in activation and shut off while requiring minimal sensor area. Water savings of up to 85% are possible with the use of a sensor faucet due to the quick automatic shut off functionality. You can expect reliable operation as our solenoid has been tested up to 2.7 million cycles. Install with confidence knowing our commitment to commercial fixtures started in 1869. The experience speaks for itself.

SPEAKMAN.COM
1 (800) 537-2107

On a daily basis, faucets are handled more than any other fixture on your property. With faucets, longevity is key, which is why it's incredibly important to select items that will stand the test of time. Our SENSORFLO® line of commercial faucets is known as the workhorse of our entire selection, including an IR sensor on each faucet.

SENSORFLO® BATTERY POWERED LOW ARC SENSOR FAUCET



SF-8700
SF-8700-TMV
Battery Powered Sensor Faucet
TMV = Thermostatic Mixing Valve



SFC-8790
Low Arc Sensor Faucet and Soap Combination

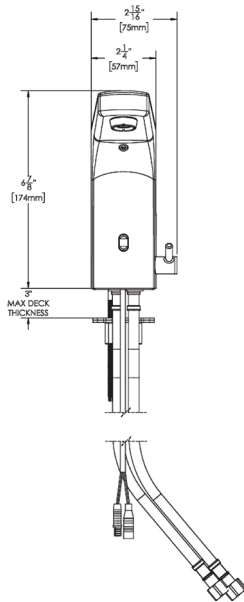

Spout Reach: 4.63"
Dimensions:
2.25"W x 5.5"H x 6.38"L

A sleek design in a highly functional package, the battery operated SENSORFLO® Sensor Faucet with thermostatic mixing valve is designed to provide years of hygienic and trouble-free service. The low arc style has all components integrated above the counter (including batteries), making it easy to install and maintain. The front-facing sensor incorporates advanced laser technology, emitting a non-visible beam of light for instant on and off operation.

Features:

- 0.5 GPM (1.89 L/min) flow rate
- Durable low lead brass construction
- Front facing laser sensor eye
- Faucet battery powered operation requires 6 AA batteries (included)
- SFC-8790 set-up for both battery (4-D batteries) and AC operation (AC adapter included)
- 2000ml soap bottle included with SFC-8790
- Vandal resistant body & hardware
- Solenoid life exceeds 2.7 million cycles
- Includes 1070 Certified Thermostatic Mixing Valve
- Meets ASME A112.18.1/CSA B125.1, NSF 372 & CEC Standards
- NSF61 IAPMO Certified
- Low Lead Law IAPMO Certified
- ADA Compliant
- 5 Year Limited Warranty (commercial)



A-TMV
**UNDER COUNTER
THERMOSTATIC MIXING
VALVE**

An industry best with low cost/high performance, our A-TMV Under Counter Thermostatic Mixing Valve is a compact thermostatic mixing valve for use with a variety of faucet installations. A-TMV regulates outlet temperature of water to ensure safe & tepid water is delivered to the user. A-TMV has a compact footprint that allows for easier installations under counter with 3/8" compression male threaded inlets & outlet.

Features:

- Minimum flow rate is 0.35 GPM (1.3 L/min)
- 3/8" compression male threaded inlets & outlet
- Hot water inlet temperature range: 120° F to 180° F
- Cold water inlet temperature range: 37° F to 80° F
- Outlet water temperature range: 80° F to 120° F
- Minimum temperature differential: 18° F (hot water supply to valve set point)
- Compact design allows for easier under counter installation
- Certified to ASSE 1070
- cUPC certified
- 3 Year Limited Warranty (commercial)

These products have been designed and engineered to the highest standard. Some products feature a unique design that stores select internal components above the counter - these products exist for ease of maintenance and to repel vandalism. We constructed each shell out of brass and metal materials to provide unrivaled durability. This is SENSORFLO®, a better faucet, inside and out.



SF-4DECK
SF-8DECK

SF-8700 DECK PLATE 4" & 8"

The Speakman Sensor Faucet Deck Plates are available in both 4-inch and 8-inch lengths to accommodate any surface. The deck plates are engineered to work with Speakman Sensorflo Deck Mounted Faucets (SF-8700, SF-8700-TMV).

Features:

- Durable brass construction
- SF-4DECK For 4" centerset installations
- SF-8DECK For 8" widespread installations
- Compatible with Sensorflo faucets
- Clean, modern design
- Easy to install
- Corrosion-resistant finish
- 1 Year Limited Warranty (commercial)



SEF-4DECK
SEF-8DECK

SF-9700 DECK PLATE 4" & 8"

The Speakman Sensor Faucet Deck Plates for deck mounted faucets SF-9700 & SF-9700-TMV are available in both 4-inch and 8-inch lengths to accommodate any surface.

Features:

- Durable brass construction
- SEF-4DECK For 4" centerset installations
- SEF-8DECK For 8" widespread installations
- Compatible with Sensorflo faucets
- Clean, modern design
- Easy to install
- Corrosion-resistant finish
- 1 Year Limited Warranty (commercial)

SENSORFLO® BATTERY POWERED DESIGNER SERIES SENSOR FAUCET



SF-9700
SF-9700-TMV
Battery Powered Designer Series Sensor Faucet
TMV = Thermostatic Mixing Valve



SFC-9790
Designer Series Sensor Faucet and Soap Combination



Add sensor functionality while maintaining the aesthetic you're after: the AC-operated SENSORFLO® Sensor Faucet provides years of hygienic and trouble-free service in a sleek package. The thin, modern spout features an advanced laser sensor incorporated near the faucet aerator for reliable operation without a visible sensor.

Features:

- 0.5 GPM (1.89 L/min) flow rate
- 4" centerset durable brass construction faucet
- Concealed laser sensor eye
- SF-9700 battery powered operation requires 6 AA batteries (included)
- 60 second time out feature for faucet
- SFC-9790 set-up for both battery (4-D batteries) and AC operation (AC adapter included)
- 2000ml soap bottle included with SFC-9790
- Vandal resistant body & hardware
- Solenoid life exceeds 2.7 million cycles
- Includes 1070 Certified Thermostatic Mixing Valve
- Thermostatic mixing valves available for tepid water
- Meets ASME A112.18.1/CSA B125.1, NSF 372 & CEC Standards
- NSF61 IAPMO Certified
- Low Lead Law IAPMO Certified
- ADA Compliant
- 5 Year Limited Warranty (commercial)

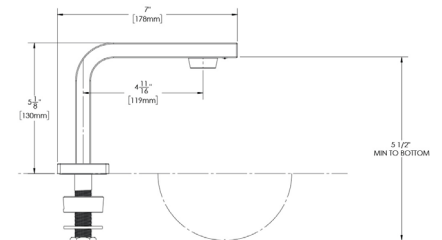

Spout Reach: 7"
Dimensions:
7"W x 5.125"H x 6.75"L

Speakman helps maximize hygiene at the sink with two different designs of Touchless Soap Dispensers for both classic and modern bathrooms alike. Constructed of durable brass, provides years of hygienic and trouble-free service. Designed to coordinate with all SENSORFLO® faucets, you get reliable operation and easy installation. The sensor incorporates advanced laser technology, emitting a non-visible beam of light for instant on and off operation.



SFS-8000
Classic Sensor Soap
Dispenser



SFS-9000
Designer Sensor Soap
Dispenser

SENSORFLO® TOUCHLESS SOAP DISPENSERS

Features:

- Durable brass construction
- Polished chrome finish
- Set-up for both battery (4-D batteries) and AC operation (AC adapter included)
- 2000ml soap bottle included
- Can be used with both liquid and foaming hand soap
- 1.0 second soap dispensing
- Sensor eye near base of soap dispenser

WARRANTY

5 Year Limited Warranty: Speakman commercial and hospitality plumbing products are warranted to be free of defects in material and workmanship for 5 years from date of installation. ("Warranty Period"). Speakman warrants to its purchasers only ("Buyer") that goods are sold free from defects in materials and workmanship and conform to Speakman's specifications at the time of manufacturing, provided the goods are properly installed and maintained. Buyer's sole and exclusive remedy for any goods that may prove to have had a non-conformance within the Warranty Period shall be, at Speakman's sole option, the repair or replacement of the non-conforming goods.

3 Year Limited Warranty: Speakman Safety products are warranted to be free of defects in material and workmanship for 3 years from date of installation. ("Warranty Period") Speakman warrants to its purchasers ("Buyer") that goods are sold free from defects in materials and workmanship and conform to Speakman's specifications at the time of manufacturing, provided the goods are properly installed and maintained. Buyer's sole and exclusive remedy for any goods that may prove to have had a non-conformance within the Warranty Period shall be, at Speakman's sole option, the repair or replacement of the non-conforming goods.

1 Year Limited Warranty: Speakman bathroom accessories and commercial shower heads are warranted to be free of defects in material, workmanship, and for functionality on commercial shower heads for 1 year from date of installation. Speakman warrants to its purchasers ("Buyer") that goods are sold free from defects in materials and workmanship and conform to Speakman's specifications at the time of manufacturing, provided the goods are properly installed and maintained. Buyer's sole and exclusive remedy for any goods that may prove to have had a non-conformance within the Warranty Period shall be, at Speakman's sole option, the repair or replacement of the non-conforming goods.

SPEAKMAN®

www.speakman.com

SPK-Sensorflo-CommFaucetBro-21